

RACORDAREA SAPEI DE PROTECTIE SI FIXAREA GEODRENULUI
PROTECTION BLANKET FILLET AND GEODREN CONNECTION
Sc.1:20

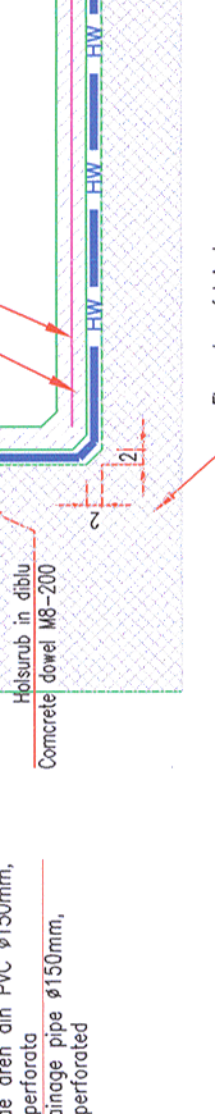
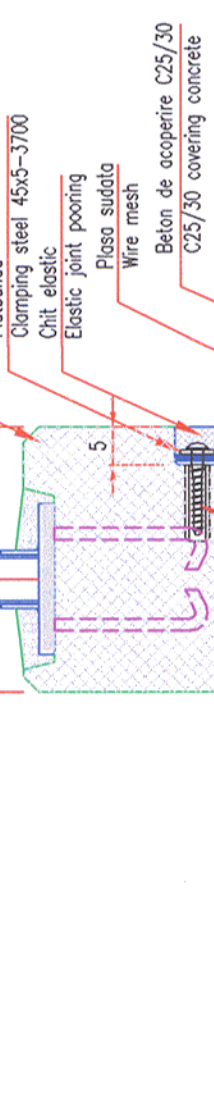
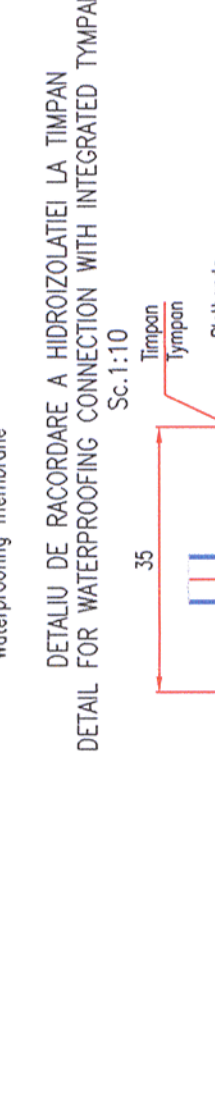
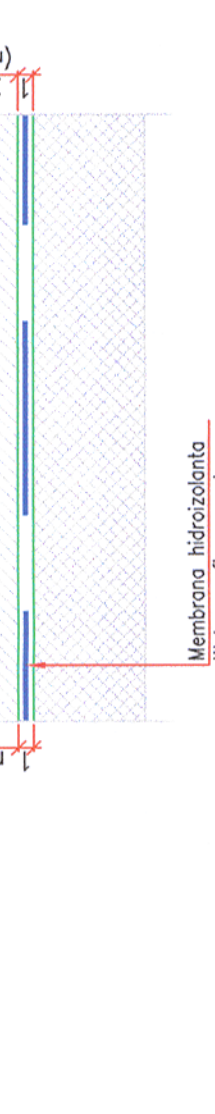
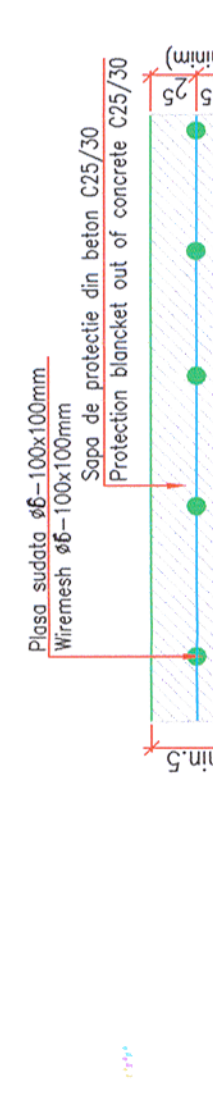
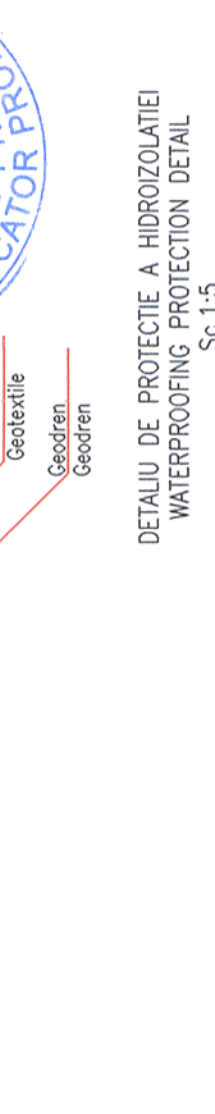
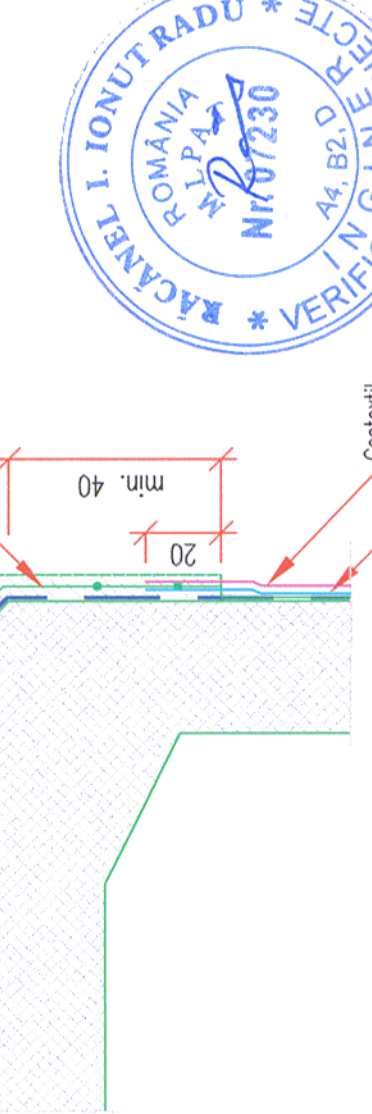
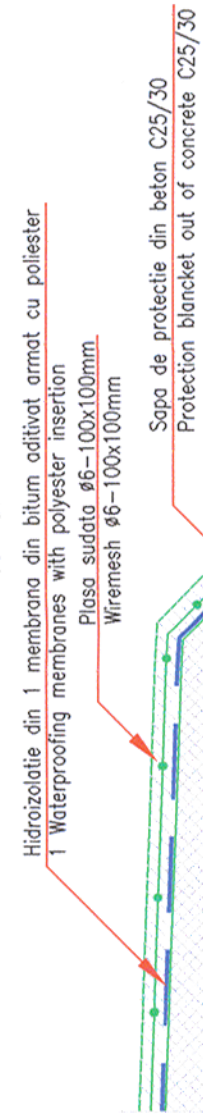

Prezentul plan anuleaza si inlocuieste versiunea anterioara
This plan cancels and replaces previous version

European Investment Bank		MINISTERUL TRANSPORTURILOR		
BENEFICIAR / BENEFICIARY :		COMPANIA NAȚIONALĂ DE CĂI FERATE "CFR" SA		Referat / Expertiza Report / Expertise
PROIECTANT / DESIGNER:				Data Date
Aprobat Approved	Sef de echipa Team leader	C. Teodorescu	01.2013	Semnatura Signature
Verificat Checked	Expert Cheie Key Expert	R. Tudorascu	01.2013	
Subcontractant / Subcontractor				
Aprobat Approved	Adjunct Sef de echipa Deputy Team leader	A.M. Baicu	01.2013	
Proiectat Designed	Inginer Engineer	F. Ioanidi	01.2013	
		Project 9i		
		Pan - European pentru circulația trenurilor cu viteză maximă de 160 km/h"		
		Tronsonul 2 : km 614 - Gurasada		
		"Rehabilitarea liniei c.f. Frontieră - Curtici - Simeria, parte componentă a coridorului IV"		
		Pan - European Corridor for the Trains Circulation with maximum speed of 160 km/h"		
		Section 2 : km 614 - Gurasada		
Denumire desen / Drawing name:				
HIDROIZOLATIE SI SISTEM DE DRENARE PODETE WATERPROOFING AND DRAINAGE SYSTEM CULVERTS				
Scara / Scale	1:50 1:20 1:10	Revizia / Revision	1/05.2013	Nr / No
		Cod desen / Drawing Code	PT.02.02.00.PO.002	
Format/Size 600x287mm				